

NOTES:

1. DIMENSIONS ARE INCH[mm].

REVISION HISTORY			
REV	DESCRIPTION	DATE	APPROVED
A	RELEASE	11/4/2004	-

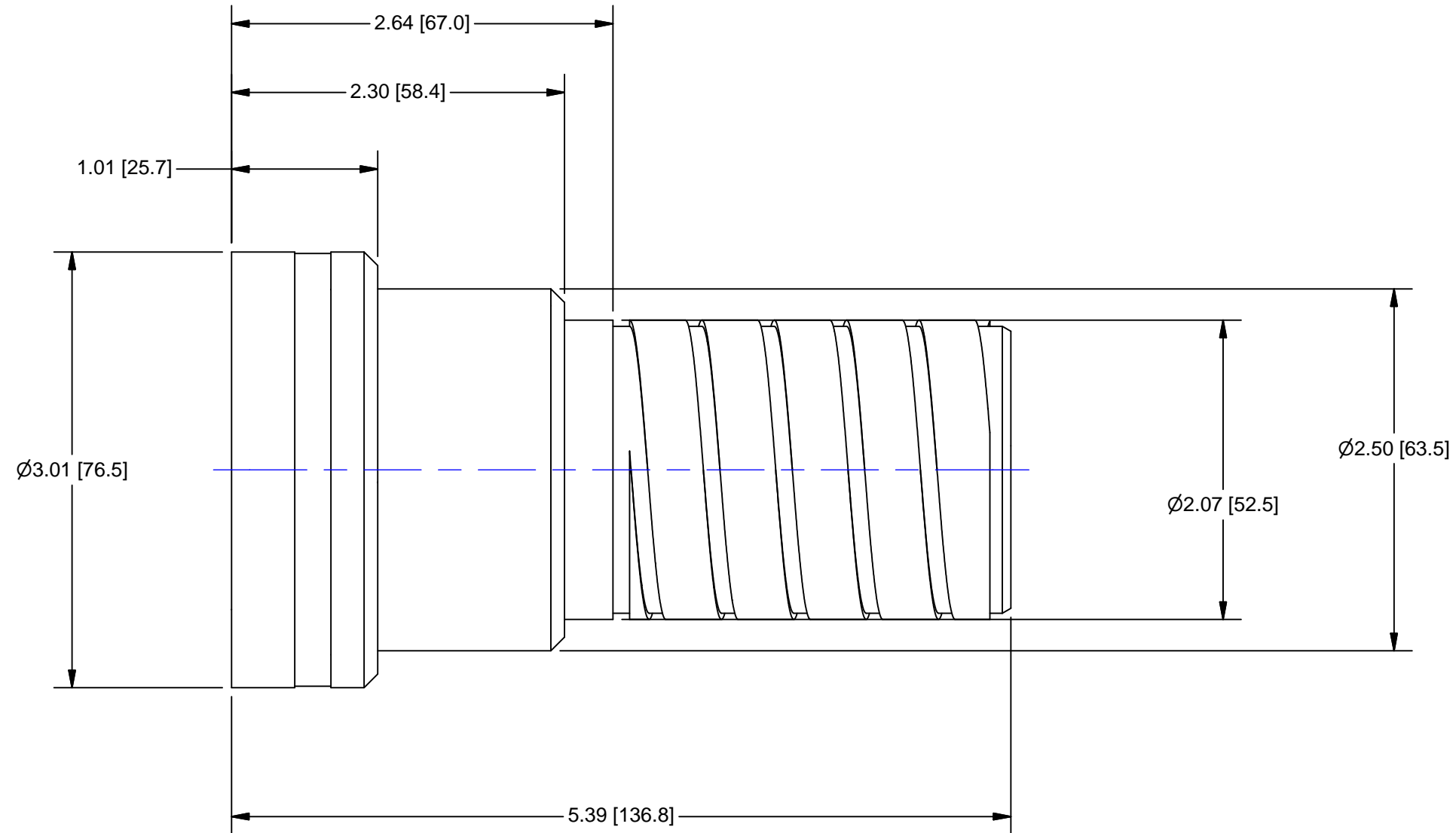

DATA:

EFL: 30.9mm  
 BFL @ INFINITY: 60.0mm  
 WT.: 1.60 LBS. [.73 KG.]

OUTLINE

USED ON:

MATERIAL:

UNLESS OTHERWISE SPECIFIED  
 DIMENSIONS ARE IN INCHES AND  
 INCLUDE CHEMICALLY APPLIED  
 OR PLATED FINISHES

P/N SUFFIX DEFINITION

- 1 CONVERSION COATING
- 2 PAINTING
- 3 MARKING
- R REWORK

THE CONTENTS OF THIS  
 DOCUMENT ARE PROPRIETARY  
 TO NAVITAR, ITS USE IS  
 AUTHORIZED ONLY FOR  
 RESPONDING TO REQUEST FOR  
 QUOTATION OR PERFORMANCE  
 OF WORK FOR NAVITAR



FINISH:

TOLERANCES AS FOLLOWS

DEC. .XXX ± .005  
 DEC. .XX ± .010  
 FRACT. ± 1/64  
 ANGLES ± 30'  
 CONCENTRICITY .003 TIR

BREAK ALL SHARP EDGES  
 .005 MIN. .010 MAX.

CHAMFER ALL THREADS 30°  
 TO ROOT DIAMETER

MAX. SURF. ROUGHNESS:  $\sqrt{32}$

SCALE: 1:1

DR: JK

CH: PB

APP: PB

DATE DR: 9/30/2004

DO NOT SCALE DRAWING

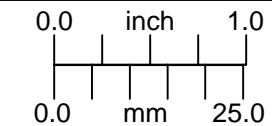

30mm LCD LENS ASS'Y

SIZE  
**B**

**MCL012**

SHEET 1 OF 1

REV  
**A**